

# Blade SLAB AND TIMBER INSTALLATION

UP TO 29 LITRES PER MINUTE

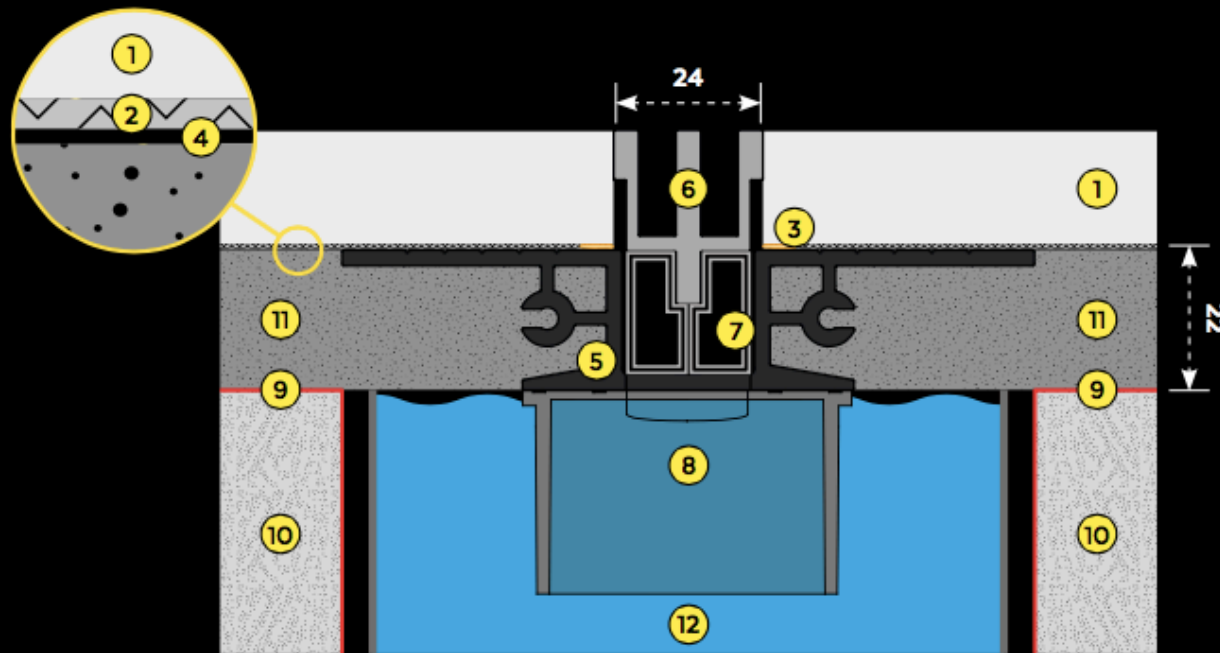

- 1 Tile
- 2 Tile adhesive
- 3 Silicon joint
- 4 Waterproof tape (Optional)
- 5 BLADE extrusion channel
- 6 BLADE removable top
- 7 Height adjustable tile spacer
- 8 Spigot 47mm fits 50mm
- 9 Waterproof membrane
- 10 Concrete slab
- 11 Screed
- 12 Pipe 50mm, 80mm or 100mm